

**3025 SE Doubleton Drive**  
**3 Bedrooms • 4.5 Baths**

- ✦ Custom-built classic Willoughby Estate Home
- ✦ Quality CBS construction / Flat tile roof
- ✦ Spectacular views of 9<sup>th</sup> fairway & Lake Willoughby
- ✦ Exquisite polished "Prima Nevada" marble floors
- ✦ Casement windows (many w/ transom glass above)
- ✦ Recently freshly painted inside & outside
- ✦ Exquisite chandeliers & fixtures throughout
- ✦ Plush white carpet in living room & bedrooms
- ✦ Newer wood floor in 3<sup>rd</sup> bedroom (den/office)
- ✦ Volume ceilings & crown moldings living & dining rooms
- ✦ Coral stone fireplace in step down living room
- ✦ Stunning dining room has tray ceiling & mirrored wall
- ✦ Sparkling mirrored wet bar with built-in icemaker
- ✦ Pocketing sliding glass doors – living & family rms.
- ✦ Custom wood cabinetry & tray ceiling in kitchen
- ✦ Corian countertops & large breakfast bar
- ✦ Sub-Zero refrigerator with matching panel doors
- ✦ Center preparation island with Thermador cooktop
- ✦ Breakfast nook features garden bay window
- ✦ Spacious family room has pocket sliders on 2 walls
- ✦ Built-in entertainment center w/ lighted display cases
- ✦ Double door entry to spacious master suite
- ✦ His & Her walk-in-closets w/ custom shelving
- ✦ Elegant master bath w/skylight & soffit lighting
- ✦ Elevated jetted Roman tub w/ marble surround
- ✦ Separate glass-enclosed shower & bidet
- ✦ Den (3<sup>rd</sup> bedroom) features custom desk & bookcases
- ✦ Bedroom #2 includes walk-in-closet & bath
- ✦ Covered lanai overlooks screened custom pool & spa
- ✦ Newer screened enclosure over pool/spa (to storm code)
- ✦ Newly-refinished "Kool" deck surface
- ✦ Charming "side" porch w/summer kitchen
- ✦ Full cabana bath off side porch
- ✦ Ceiling fans & central vacuum system
- ✦ Custom window treatments throughout
- ✦ Newly sealed "Bomanite" circular driveway
- ✦ Water softener & reverse osmosis system
- ✦ Two car garage plus side golf cart garage
- ✦ Beautifully landscaped including mature palms

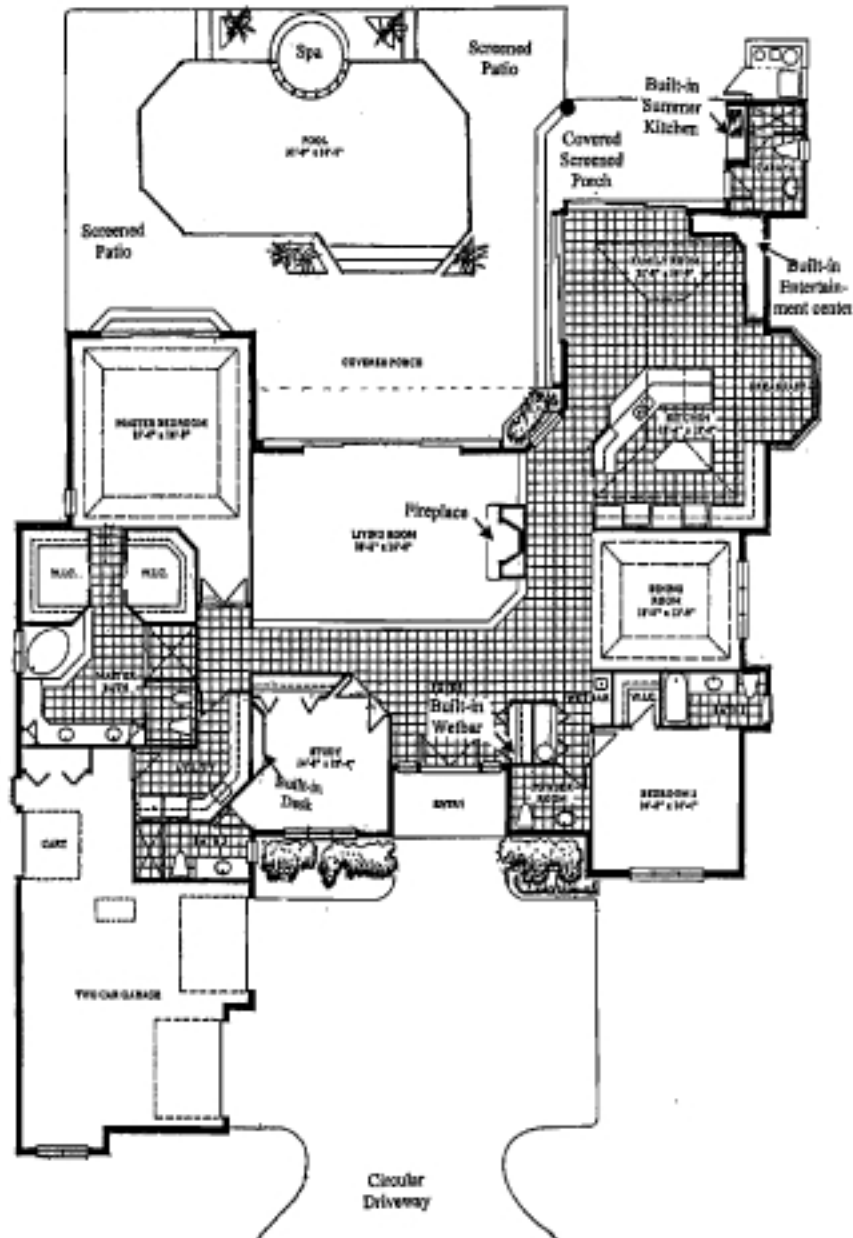

<b>SQUARE FOOTAGE</b>	
A/C Area	3,535
Total Area	4,860