

Willoughby Office  
(772) 220-7877  
willoughbysales.com

# FENTON LANG BRUNER & ASSOCIATES

LICENSED REAL ESTATE BROKER

Est. 1947

Exclusive Affiliate of  
**CHRISTIE'S**  
GREAT ESTATES

## Willoughby Golf Club



Information deemed reliable but not guaranteed



772-220-7877  
**FentonandLang.com**  
 Virtual Tour Online

**FENTON LANG BRUNER  
 & ASSOCIATES**  
 LICENSED REAL ESTATE BROKER  
 Est. 1947

Exclusive Affiliate of  
**CHRISTIE'S**  
 GREAT ESTATES

**4682 SE Waterford Drive**

**3 Bedrooms • Den • 4 Baths**

**\$775,000**

- ✘ Quality built custom home - impeccable in every way
- ✘ Eastern exposure with golf course views
- ✘ New high-impact solid wood entry doors w/ transom & sidelights
- ✘ Built in 2001- Newly painted interior & exterior
- ✘ Exquisite new chandelier in foyer
- ✘ 20" ceramic tile floors w/ mosaic borders - main living areas
- ✘ Volume ceilings & crown moldings throughout
- ✘ Octagonal tray ceiling & sliding glass doors to patio - living room
- ✘ Coffered ceiling in dining room, master bedroom & master bath
- ✘ 8' solid-core interior doors with applied moldings throughout
- ✘ Formal dining room has archway, columns, chairrail & faux paint
- ✘ Exquisite chandelier in dining room & light fixtures throughout
- ✘ Windows are trimmed out & most have transom glass above
- ✘ Plantation shutters & charming custom window treatments
- ✘ Fully remodeled "Downsview" kitchen w/ granite countertops
- ✘ Elevated breakfast bar & extended chair-level countertop
- ✘ Decorative tumbled marble backsplash & under-cabinet lighting
- ✘ Built-in Wolf double ovens (1 micro/convection)
- ✘ Wolf smooth-top range with elegant wood range hood
- ✘ 42" Kitchen-Aid refrigerator & Miele dishwasher
- ✘ Richly finished 50" custom wood cabinets with crown molding
- ✘ Pull-out drawers in cabinetry & customized walk-in pantry
- ✘ Breakfast nook features butte glass window & chandelier
- ✘ Bright and open family room – perfect for entertaining
- ✘ Granite-topped wet bar has high glass & pass-thru to patio
- ✘ Pocket doors lead to den with faux finished walls
- ✘ Double entry doors to spacious master suite
- ✘ Master suite has Berber carpet & French door to patio
- ✘ His & Her master walk-in-closets w/ custom shelving
- ✘ Master bath features marble vanities & gold fixtures
- ✘ Butte-glass above Roman tub offers lovely "garden" view
- ✘ Lighted art niche in entry to guest hallway
- ✘ Split plan offers guest wing with 2 private guest suites
- ✘ Newly painted guest suites w/ walk-in closets & baths
- ✘ Exquisite powder room can also serve as "cabana" bath
- ✘ Ceiling fans in family room & bedrooms
- ✘ 2 water heaters (1 recently replaced)
- ✘ Two covered lanais overlook pool (1 with summer kitchen)
- ✘ Air-conditioned storage room off garage
- ✘ 2-zoned air-conditioning systems
- ✘ Newly painted walls & floor in 2 car + golf cart garage
- ✘ Storm shutters for all windows
- ✘ May also be purchased fully furnished (Ask associate)

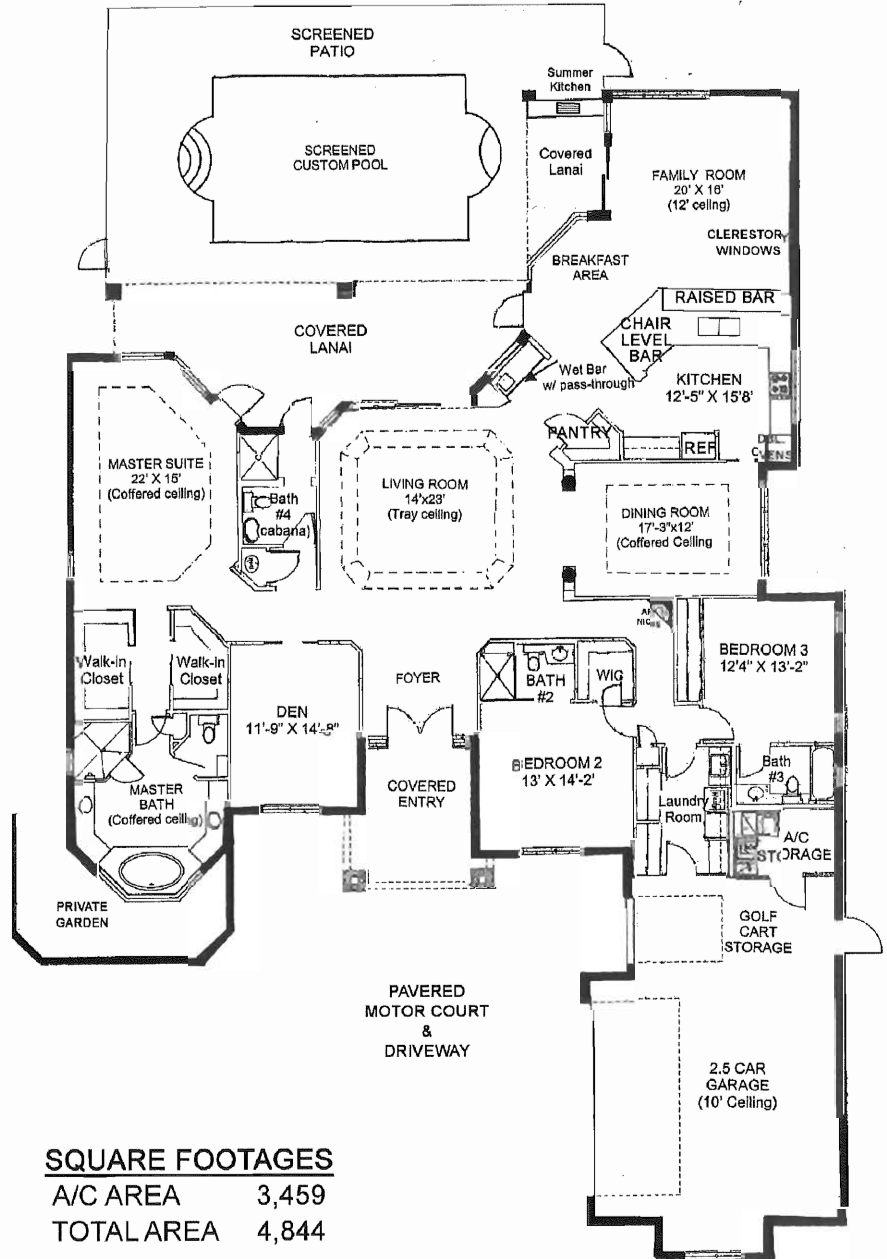

**SQUARE FOOTAGES**

A/C AREA	3,459
TOTAL AREA	4,844

*Price and terms are subject to change without notice. This is a rendering only. Dimensions represented are approximate. This information cannot be reproduced without permission from Fenton Lang Bruner & Associates*