

Willoughby Office
(772) 220-7877
www.willoughbysales.com
www.fentonandlang.com

FENTON LANG BRUNER
& ASSOCIATES
LICENSED REAL ESTATE BROKER

Est. 1947

Exclusive Affiliate of
CHRISTIE'S
GREAT ESTATES

Willoughby Golf Club



Willoughby Office 772-220-7877
 Stuart Office 772-220-9420
 Jupiter Island 772-546-2381
 Hobe Sound 772-546-4466
 Jupiter Hills 561-746-6065

**FENTON LANG BRUNER
 & ASSOCIATES**
 LICENSED REAL ESTATE BROKER

Exclusive Affiliate of
CHRISTIE'S
 GREAT ESTATES

1-800-587-4753

960 SE INDIAN STREET, STUART, FL 34997

www.fentonandlang.com

1290 S.E. Brewster Place
2 Bedrooms · Den · 2.5 Baths

\$519,000

- ✱ C.B.S. Construction & concrete flat tile roof
- ✱ Premium location with valued eastern exposure
- ✱ Breathtaking lake views w/ golf course & clubhouse
- ✱ Beautiful Saturnia marble floors (laid on diagonal)
- ✱ Great "curb appeal" – lush landscaping & exterior painted
- ✱ Spacious great room features high vaulted ceiling
- ✱ Custom cabinetry & decorative moldings – Great room
- ✱ Pocketing sliding glass doors open onto covered lanai
- ✱ Custom window treatments & blinds throughout
- ✱ Refurbished kitchen including granite counters
- ✱ Kitchen has newer Kitchen Aid convection oven & cooktop
- ✱ 42' cabinets with plus custom-built pantries
- ✱ Newer Maytag refrigerator with lower freezer drawer
- ✱ Charming breakfast nook overlooks private patio
- ✱ Family room has sliding glass doors to lanai
- ✱ Built-in entertainment center in family room
- ✱ Den/Library offers double entry doors & built-ins
- ✱ Guest suite #2 has walk-in closet & cabana bath
- ✱ Spacious master suite has vaulted ceiling
- ✱ Expanded master suite includes large sitting room
- ✱ Sitting room has bay window & Murphy bed
- ✱ His & Her closets (1 Walk-in) w/ custom shelving
- ✱ Master bath has skylight & corner Roman tub
- ✱ Office or Bonus room has built-in desk
- ✱ Ceiling fans & central vacuum system
- ✱ Kitchen Aid washer & dryer included in laundry room
- ✱ Security System & stereo speakers
- ✱ Family room has French doors leading to porch
- ✱ Large covered lanai includes cabinetry & wetbar
- ✱ Screened patio features (heated) pool & spa
- ✱ Hand laid paver driveway, walks & pool deck
- ✱ 2-car garage plus golf cart & built-in storage
- ✱ Accordion storm shutters
- ✱ Newer Trane air-conditioning system

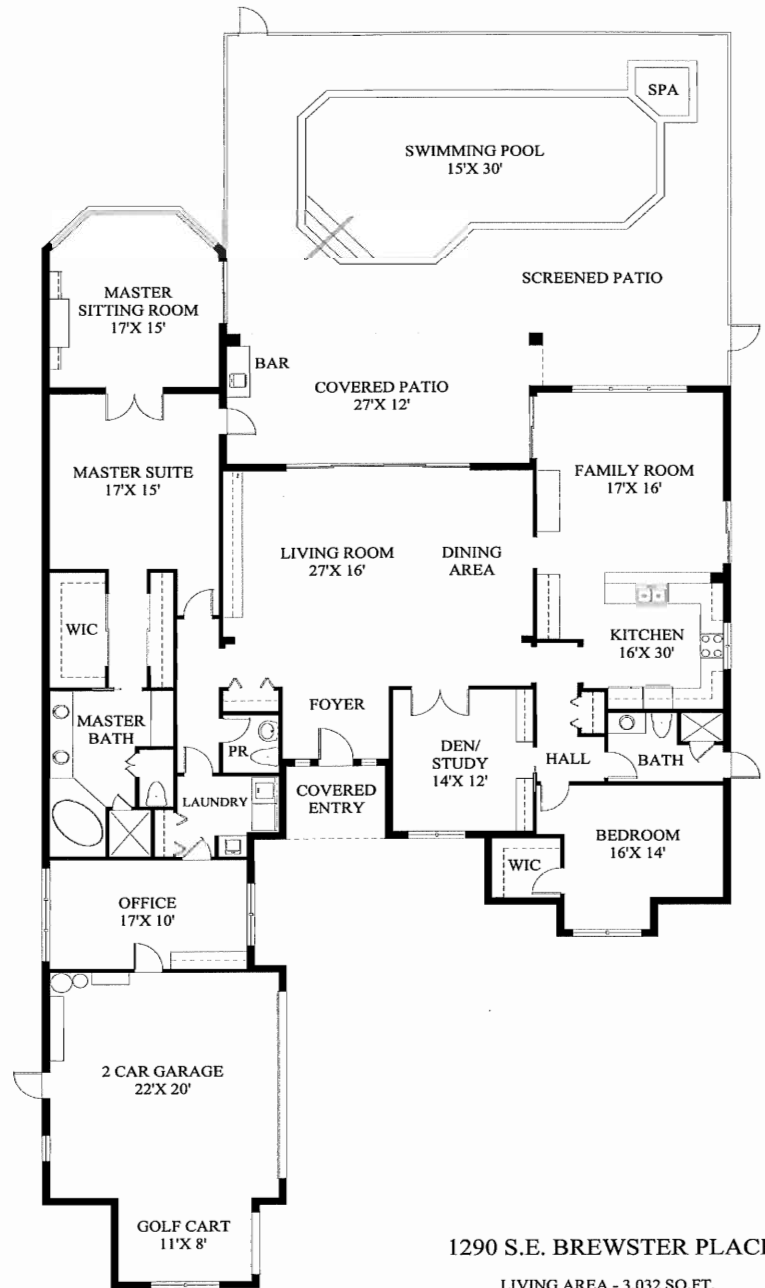

1290 S.E. BREWSTER PLACE

LIVING AREA - 3,032 SQ.FT.
 TOTAL AREA - 4,011 SQ.FT.

Virtual Tour Online @ www.fentonandlang.com

*Price and terms are subject to change without notice. This is a rendering only. Dimensions represented are approximate.
 This information cannot be reproduced without permission from Fenton Lang Bruner & Associates*